

BE

FULL-CONE NOZZLES

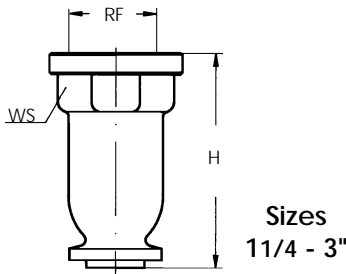

Sizes
1 1/4 - 3"

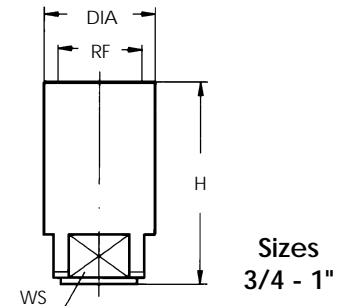

Sizes
3/4 - 1"

BE two-piece nozzles produce a full-cone spray, with angles ranging between 60° and 120°. The even spray distribution results from the design of the inner whirling vane. These nozzles can be used in applications where complete surface coverage is required.

Models up to 1" in thread diameter are machined. All other nozzles in this series are castings.

Connection: Female thread

Materials: Brass (T1)
303 stainless steel (B1)
316 stainless steel (B3)

Nozzle code	RF	D	D1	Flow rates (gpm) at various pressures (psi)											Spray angle			Dimensions						
				3	5	7	10	20	30	40	60	80	100	150	7 psi	20 psi	80 psi	H	WS	DIA				
				BEQ 2220 xx SN	3/4"	0.193	0.173	1.5	2.0	2.3	2.8	4.0	4.9	5.6	6.9	7.9	8.9	10.9	12.6	14.1	10.9	17.3	67	70
BEQ 2350 xx SN		0.252	0.173	2.4	3.2	3.7	4.5	6.3	7.7	8.9	10.9	12.6	14.1	17.3	19.1	22.0	24.6	30.2	89	92	84			
BEQ 2610 xx SN		0.374	0.205	4.3	5.5	6.5	7.8	11.0	13.5	15.6	19.1	22.0	24.6	30.2	32.5	37.5	42.0	51.4	89	92	84			
BEW 2500 xx SN		0.386	0.173	3.5	4.5	5.3	6.4	9.0	11.1	12.8	15.6	18.0	-	-	115	120	112							
BES 2370 xx SN	1"	0.236	0.220	2.6	3.3	4.0	4.7	6.7	8.2	9.4	11.6	13.4	14.9	18.3	48	50	46	249/64"	19/32"	11/2"				
BES 2611 xx SN		0.327	0.220	4.3	5.5	6.5	7.8	11.0	13.5	15.6	19.1	22.0	24.6	30.2	67	68	62							
BES 2870 xx SN		0.468	0.220	6.1	7.9	9.3	11.1	15.7	19.2	22.2	27.2	31.4	35.1	43.0	78	90	94							
BES 3104 xx SN		0.468	0.252	7.3	9.4	11.1	13.3	18.8	23.0	26.5	32.5	37.5	42.0	51.4	89	92	84							
BEW 2920 xx SN		0.516	0.220	6.4	8.3	9.8	11.7	16.6	20.3	23.5	28.8	33.2	-	-	117	120	117							
BES 2520 xx SN	1 1/4"	0.291	0.252	3.6	4.7	5.6	6.6	9.4	11.5	13.3	16.3	18.8	21.0	25.7	48	50	44	37/16"	23/16"					
BES 2871 xx SN		0.378	0.252	6.1	7.9	9.3	11.1	15.7	19.2	22.2	27.2	31.4	35.1	43.0	64	67	58							
BES 3105 xx SN		0.421	0.252	7.3	9.5	11.2	13.4	19.0	23.2	26.8	32.8	37.9	42.4	51.9	66	70	60							
BES 3122 xx SN		0.484	0.252	8.5	11.0	13.0	15.6	22.0	27.0	31.1	38.1	44.0	49.2	60.3	77	80	70							
BES 3174 xx SN		0.594	0.311	12.2	15.7	18.6	22.2	31.4	38.5	44.4	54.4	62.8	70.2	86.0	90	93	81							
BEW 3134 xx SN		0.610	0.252	9.4	12.1	14.3	17.1	24.2	29.6	34.2	41.9	48.4	-	-	118	121	119							
BES 2872 xx SN	1 1/2"	0.374	0.342	6.1	7.9	9.3	11.1	15.7	19.3	22.3	27.3	31.5	35.2	43.1	48	50	44	41/64"	21/16"					
BES 3139 xx SN		0.500	0.342	9.7	12.5	14.8	17.2	25.1	30.7	35.5	43.5	50.2	56.1	68.7	72	74	64							
BES 3175 xx SN		0.567	0.342	12.2	15.8	18.7	22.3	31.6	38.7	44.7	54.7	63.2	70.6	86.5	74	76	66							
BES 3260 xx SN		0.720	0.405	18.2	23.5	27.8	33.2	46.9	57.5	66.4	81.3	93.9	105	129	91	94	82							
BEW 3200 xx SN		0.716	0.405	14.0	18.0	21.4	25.5	36.1	44.2	51.0	62.5	72.2	-	-	119	124	119							
BES 3148 xx SN	2"	0.500	0.437	10.3	13.4	15.8	18.9	26.7	32.7	37.8	46.3	53.4	59.7	73.2	49	50	44	57/16"	225/32"					
BES 3261 xx SN		0.681	0.437	18.2	23.6	27.9	33.3	47.1	57.7	66.6	81.6	94.2	105	129	72	74	64							
BES 3305 xx SN		0.756	0.437	21.3	27.5	32.6	38.9	55.0	67.4	77.8	95.3	110	123	151	75	77	68							
BES 3350 xx SN		0.827	0.437	24.5	31.6	37.4	44.7	63.2	77.4	89.3	109	126	141	173	78	80	70							
BES 3435 xx SN		0.972	0.563	30.4	39.3	46.4	55.5	78.5	96.2	111	136	157	176	215	83	85	75							
BES 3520 xx SN		1.125	0.563	36.3	46.9	55.5	66.4	93.9	115	133	163	188	210	257	98	100	86							
BEW 3395 xx SN		0.984	0.437	27.6	35.6	42.2	50.4	71.3	87.3	101	123	143	-	-	120	124	119							
BES 3215 xx SN	2 1/2"	0.594	0.563	15.0	19.4	23.0	27.4	38.8	47.5	54.9	67.2	77.6	86.8	106	49	50	44	63/8"	311/32"					
BES 3436 xx SN		0.874	0.563	30.5	39.3	46.6	55.6	78.7	96.4	111	136	157	176	216	72	74	64							
BES 3521 xx SN		0.968	0.563	36.4	47.0	55.6	66.5	94.0	115	133	163	188	210	258	76	78	68							
BES 3610 xx SN		1.126	0.563	42.6	55.0	65.1	77.8	110	135	156	191	220	246	302	79	82	72							
BES 3700 xx SN		1.126	0.689	48.9	63.2	74.7	89.3	126	155	179	219	253	283	346	86	88	77							
BES 3780 xx SN		1.252	0.689	54.5	70.4	83.3	100	141	172	199	244	282	315	386	95	97	84							
BEW 3590 xx SN		1.252	0.563	41.2	53.2	63.0	75.3	106	130	151	184	213	-	-	120	125	119							
BEU 3365 xx SN	3"	0.725	0.689	25.5	32.9	39.0	46.6	65.9	80.7	93.2	114	132	147	180	49	50	44	723/64"	315/16"					
BEU 3701 xx SN		1.090	0.689	49.0	63.3	74.8	89.5	127	155	179	219	253	283	346	81	84	73							
BEU 3781 xx SN		1.189	0.689	54.6	70.5	83.4	100	141	173	199	244	282	315	386	86	89	77							
BEU 3870 xx SN		1.279	0.689	60.8	78.5	92.9	111	157	192	222	272	314	351	430	92	95	83							
BEU 4104 xx SN		1.374	0.811	72.7	93.9	111	133	188	230	265	325	375	420	514	102	105	89							
BEW 3800 xx SN		1.370	0.689	55.9	72.2	85.4	102	144	177	204	250	289	-	-	120	125	119							

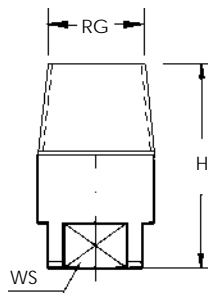

Sizes
3/4 - 1"

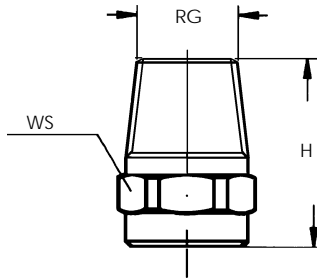

Sizes
1/4 - 1/2"

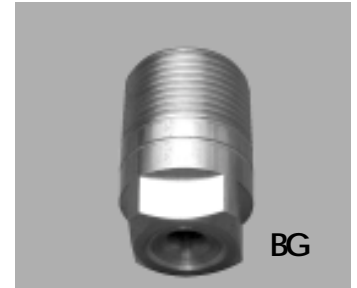

BG

BG two-piece nozzles are identical in performance to the BE style except that it has a male thread.

Connection: Male thread

Materials: Brass (T1)
303 stainless steel (B1)
316 stainless steel (B3)

Nozzle code	RG	D	D1	Flow rates (gpm) at various pressures (psi)												Spray angle			Dimensions	
				3	5	7	10	20	30	40	60	80	100	150	7 psi	20 psi	80 psi	H	WS	
				BGQ 1480 xx SN	1/4"	0.090	0.063	0.34	0.43	0.51	0.61	0.87	1.1	1.2	1.5	1.7	1.9	2.4	45	50
BGQ 1740 xx SN		0.114	0.063	0.52	0.67	0.79	0.94	1.3	1.6	1.9	2.3	2.7	3.0	3.7	58	67	61			
BGW 2100 xx SN		0.142	0.063	-	0.90	1.1	1.3	1.8	2.2	2.6	3.1	3.6	-	-	114	120	103			
BGQ 1700 xx SN	3/8"	0.102	0.094	0.49	0.63	0.75	0.89	1.3	1.5	1.8	2.2	2.5	2.8	3.5	45	50	46	113/64"	11/16"	
BGQ 2111 xx SN			0.142	0.094	0.78	1.0	1.2	1.4	2.0	2.5	2.8	3.5	4.0	4.5	5.5	64	67			61
BGQ 2163 xx SN			0.177	0.110	1.1	1.5	1.7	2.1	2.9	3.6	4.2	5.1	5.9	6.6	8.1	87	90			82
BGW 2122 xx SN			0.146	0.063	-	1.1	1.3	1.6	2.2	2.7	3.1	3.8	4.4	-	-	114	120			103
BGW 2144 xx SN			0.173	0.095	-	1.3	1.5	1.8	2.6	3.2	3.7	4.5	5.2	-	-	114	120			104
BGW 2172 xx SN			0.177	0.095	-	1.6	1.8	2.2	3.1	3.8	4.4	5.4	6.2	-	-	114	120			104
BGW 2194 xx SN			0.185	0.110	-	1.8	2.1	2.5	3.5	4.3	5.0	6.1	7.0	-	-	114	120			106
BGS 2185 xx SN	1/2"	0.181	0.126	1.3	1.7	2.0	2.4	3.3	4.1	4.7	5.8	6.7	7.5	9.1	64	67	61	117/32"	7/8"	
BGS 2300 xx SN			0.248	0.142	2.1	2.7	3.2	3.8	5.4	6.6	7.7	9.4	10.8	12.1	14.8	88	91			83
BGW 2220 xx SN		0.201	0.110	-	2.0	2.3	2.8	4.0	4.9	5.6	6.9	7.9	-	-	114	120	108			
BGW 2250 xx SN		0.232	0.126	-	2.3	2.7	3.2	4.5	5.5	6.4	7.8	9.0	-	-	114	120	108			
BGW 2290 xx SN		0.248	0.126	-	2.6	3.1	3.7	5.2	6.4	7.4	9.1	10.5	-	-	114	120	108			
BGW 2320 xx SN		0.248	0.142	-	2.9	3.4	4.1	5.8	7.1	8.2	10.0	11.6	-	-	114	120	110			
BGW 2360 xx SN		0.264	0.157	-	3.2	3.8	4.6	6.5	8.0	9.2	11.3	13.0	-	-	114	120	112			
BGS 2220 xx SN	3/4"	0.193	0.173	1.5	2.0	2.3	2.8	4.0	4.9	5.6	6.9	7.9	8.9	10.9	48	50	46	119/32"	11/16"	
BGS 2350 xx SN			0.252	0.173	2.4	3.2	3.7	4.5	6.3	7.7	8.9	10.9	12.6	14.1	17.3	67	70			63
BGS 2610 xx SN			0.374	0.205	4.3	5.5	6.5	7.8	11.0	13.5	15.6	19.1	22.0	24.6	30.2	89	92			84
BGW 2500 xx SN			0.386	0.173	-	4.5	5.3	6.4	9.0	11.1	12.8	15.6	18.0	-	-	115	120			112
BGS 2370 xx SN	1"	0.236	0.220	2.6	3.3	4.0	4.7	6.7	8.2	9.4	11.6	13.4	14.9	18.3	48	50	46	27/64"	111/32"	
BGS 2611 xx SN			0.237	0.220	4.3	5.5	6.5	7.8	11.0	13.5	15.6	19.1	22.1	24.7	30.2	67	68			62
BGS 2870 xx SN			0.468	0.220	6.1	7.9	9.3	11.1	15.7	19.2	22.2	27.2	31.4	35.1	43.0	78	90			94
BGS 3104 xx SN			0.468	0.252	7.3	9.4	11.1	13.3	18.8	23.0	26.5	32.5	37.5	42.0	51.4	89	92			84
BGW 2920 xx SN			0.516	0.220	-	8.3	9.8	11.7	16.6	20.3	23.5	28.8	33.2	-	-	117	120			117